

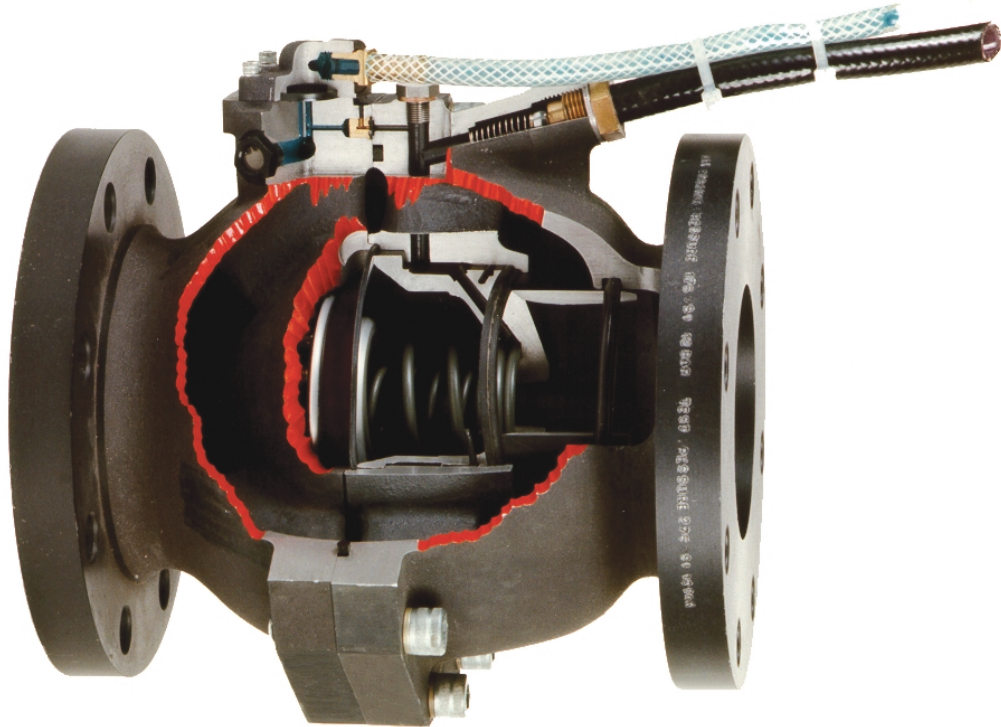

CCMY8600M2 4" INLINE PRESSURE CONTROLLER WITH DEADMAN



- High flow rates
- Accurate pressure control and low hysteresis
- Low pressure drop
- Excellent stability at all flow rates
- Flanged 4" ASA 150w
- 4"-6" ASA 150 Adaptors available
- Air referenced
- Controlled opening and closure
- Reliable diaphragm operation

OPERATION

A sliding piston automatically adjusts the pressure drop through the valve by reducing or increasing flow area. The piston is attached via a sealed stem to a diaphragm fitted in a chamber sealed off from the main flow. The diaphragm is exposed on one side to a remotely sensed fuel pressure and on the other side to reference air pressure.

The piston is spring biased to close, thus in the event of diaphragm failure or 'deadman' shut off the valve will always terminate flow.

Specification & Dimensions

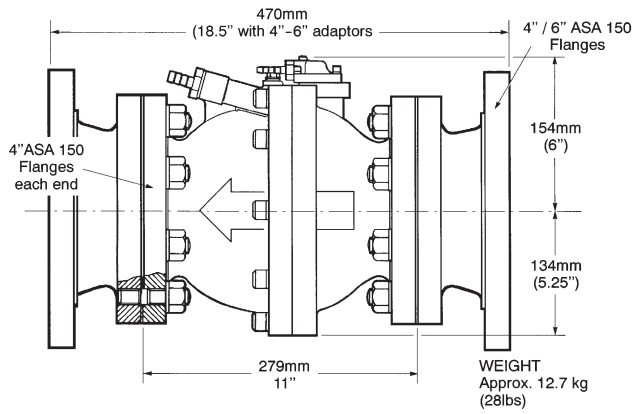

OPERATING PRESSURE CONTROL

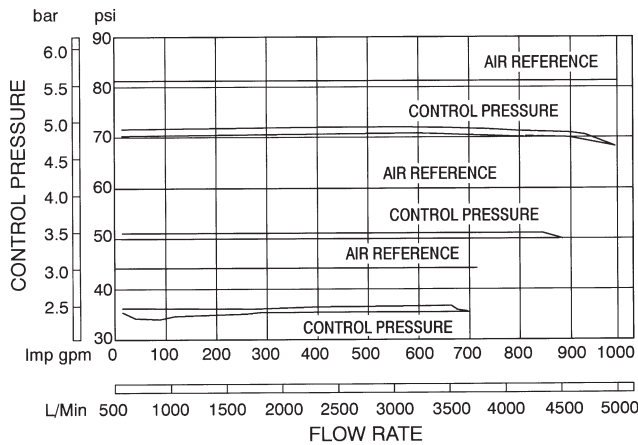

PRESSURE DROP

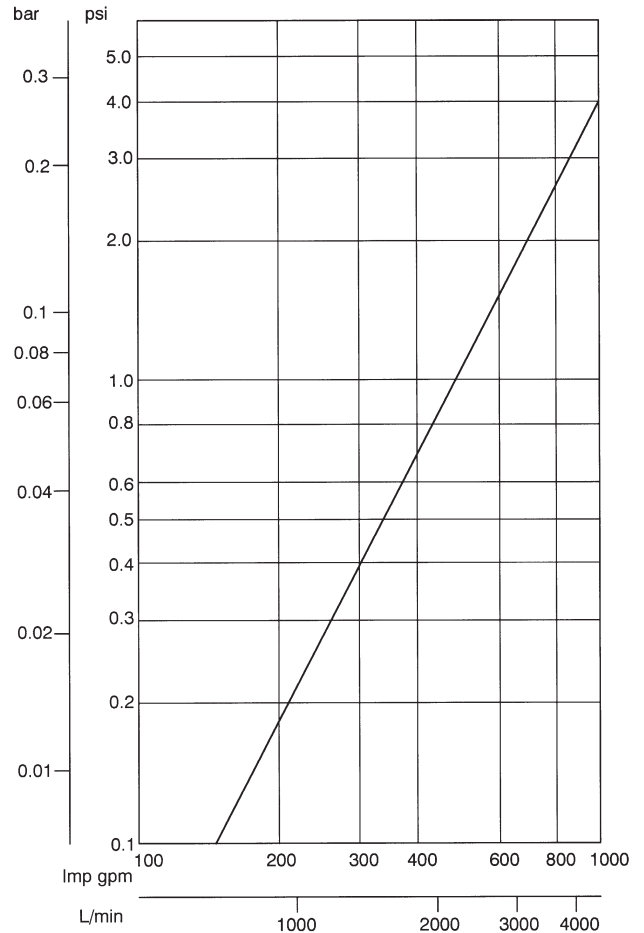

Pressure Rating	Max. Working Pressure	12.1 bar	(175 psi)
	Max. Test Pressure	19.0 bar	(275 psi)
	Max. Flow Rate	4500 l/min	
		1000 Imp.gpm	
		1200 US gpm	
Pressure Drop	At Max. Flow Rate	0.28 bar	(4 psi)
Pressure Control		± 0.14 bar	(2 psi)
Air Reference Bias		0.7-0.8 bar	(10-12psi)
DEADMAN			
Opening Time	Approx.	10.0 seconds (adjustable by	
Closing Time	Approx.	5.0 seconds fixed orifices)	
Overshoot	At Max. Flow Rate	190 Litres	
		42 Imp. gall	
		50 US gall	



Cobham Fluid Systems Limited

Holland Way, Blandford Forum, Dorset, England. DT11 7BJ
Tel: 44 (0)1258 486600 Fax: 44 (0)1258 486601
www.cobhamfluidsystems.com
sales@cobhamfluidsystems.com

Copyright: Cobham Fluid Systems.

This publication provides outline information only, which (unless agreed by the Company in writing) may not be used, applied or reproduced for any purpose or form part of any order or contract or be regarded as a representation relating to the products or services concerned. The Company reserves the right to alter without notice the specification, design, price or conditions of supply of any product or service.



A Collective Member of



A Flight Refuelling company